

FOR LEASE

855 SF FOOD COURT SPACE AVAILABE AT WESTFIELD FASHION SQUARE

14006 RIVERSIDE DRIVE, SUITE 17 | SHERMAN OAKS, CA 91432



MATT SAKER

CA REAL ESTATE LIC #02017606
310.575.1517 EXT. 237
MSAKER@CBM1.COM

1517 S. SEPULVEDA BLVD | LOS ANGELES, CA 90025
CBM1.COM



855 SF FOOD COURT SPACE FOR LEASE AT WESTFIELD FASHION SQUARE
14006 RIVERSIDE DRIVE, SUITE 17 | SHERMAN AAKS, CA 91432

FEATURES + AMENITIES



- RARE 855 SF FOOD COURT OPPORTUNITY AT WESTFIELD FASHION SQUARE
- INCLUDES FULLY BUILT-OUT KITCHEN
- SUBLEASE LEASE EXPIRES SEPTEMBER 30TH, 2026
- 6,400,000+ ANNUAL CUSTOMER VISITS
- APPROX. \$384,000,000 IN TOTAL ANNUAL RETAIL SALES
- LOCATED DIRECTLY ALONGSIDE INTERSTATE 101 AND CLOSE TO INTERSTATE 405, AMONG THE MOST HEAVILY TRAVELED HIGHWAY FREEWAY INTERCHANGES IN US. (360,000 + VEHICLES CONVERGE DAILY)

ANCHORED BY



DEMOGRAPHICS SNAPSHOT	1-MILE	3-MILE	5-MILE
POPULATION	31,353	225,618	566,427
AVG HH INCOME	\$113,169	\$106,374	\$100,712

EXCLUSIVELY REPRESENTED BY

MATT SAKER

CA REAL ESTATE LIC #02017606
310.575.1517 EXT. 237
MSAKER@CBM1.COM

SITE PLAN

14006 RIVERSIDE DRIVE, SUITE 17 | SHERMAN OAKS, CA 91432

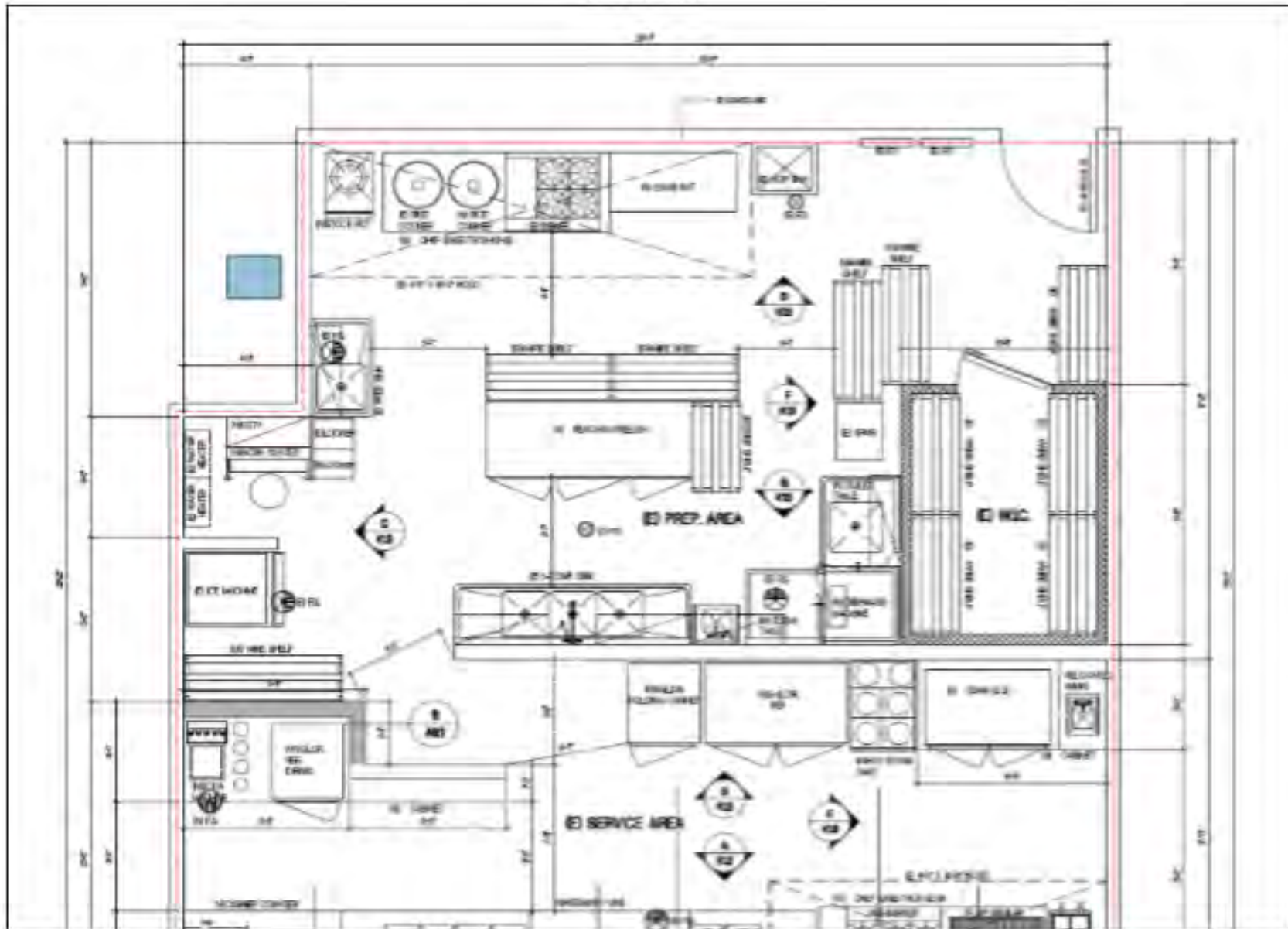

	1 mile(s)	3 mile(s)	5 mile(s)
Population: 2017A			
Total Population	31,353	225,618	566,427
Female Population	52.49%	50.89%	50.24%
Male Population	47.51%	49.11%	49.76%
Population Density	9,978	7,978	7,211
Population Median Age	39.8	38.8	37.1
Employed Civilian Population 16+	18,532	122,504	292,579
% White Collar	79.1%	68.0%	61.7%
% Blue Collar	20.9%	32.0%	38.3%
Total Q2 2017 Employees	15,876	99,497	220,948
Total Q2 2017 Establishments*	2,833	14,719	30,366
Population Growth 2000-2010	6.66%	2.88%	1.04%
Population Growth 2017A-2022	1.44%	1.07%	0.96%
Income: 2017A			
Average Household Income	\$113,169	\$106,374	\$100,712
Median Household Income	\$72,597	\$64,431	\$58,890
Per Capita Income	\$55,487	\$44,557	\$38,307
Avg Income Growth 2000-2010	46.43%	38.69%	32.28%
Avg Income Growth 2017A-2022	14.27%	14.02%	13.47%
Households: 2017A			
Households	15,345	94,134	214,611
Average Household Size	2.02	2.37	2.60
Hhld Growth 2000-2010	1.31%	1.47%	0.59%
Hhld Growth 2017A-2022	1.30%	1.99%	2.41%
Housing Units: 2017A			
Occupied Units	15,345	94,134	214,611
% Occupied Units	98.46%	97.75%	97.34%
% Vacant Housing Units	1.54%	2.25%	2.66%
Owner Occ Housing Growth 2000-2010	2.41%	1.55%	-0.45%
Owner Occ Housing Growth 2000-2022	1.36%	2.61%	0.65%
Owner Occ Housing Growth 2017A-2022	0.36%	0.80%	1.04%
Occ Housing Growth 2000-2010	1.31%	1.47%	0.59%
Occ Housing Growth 2010-2022	7.74%	8.93%	8.79%
Occ Housing Growth 2017A-2022	1.30%	1.99%	2.41%
Race and Ethnicity: 2017A			
% American Indian or Alaska Native Population	0.30%	0.47%	0.55%
% Asian Population	7.38%	6.81%	8.41%
% Black Population	5.31%	4.58%	4.40%
% Hawaiian or Pacific Islander Population	0.12%	0.10%	0.11%
% Multirace Population	4.87%	4.83%	5.12%
% Other Race Population	4.04%	13.30%	19.28%
% White Population	77.97%	69.90%	62.14%
% Hispanic Population	13.40%	30.62%	41.90%
% Non Hispanic Population	86.60%	69.38%	58.10%

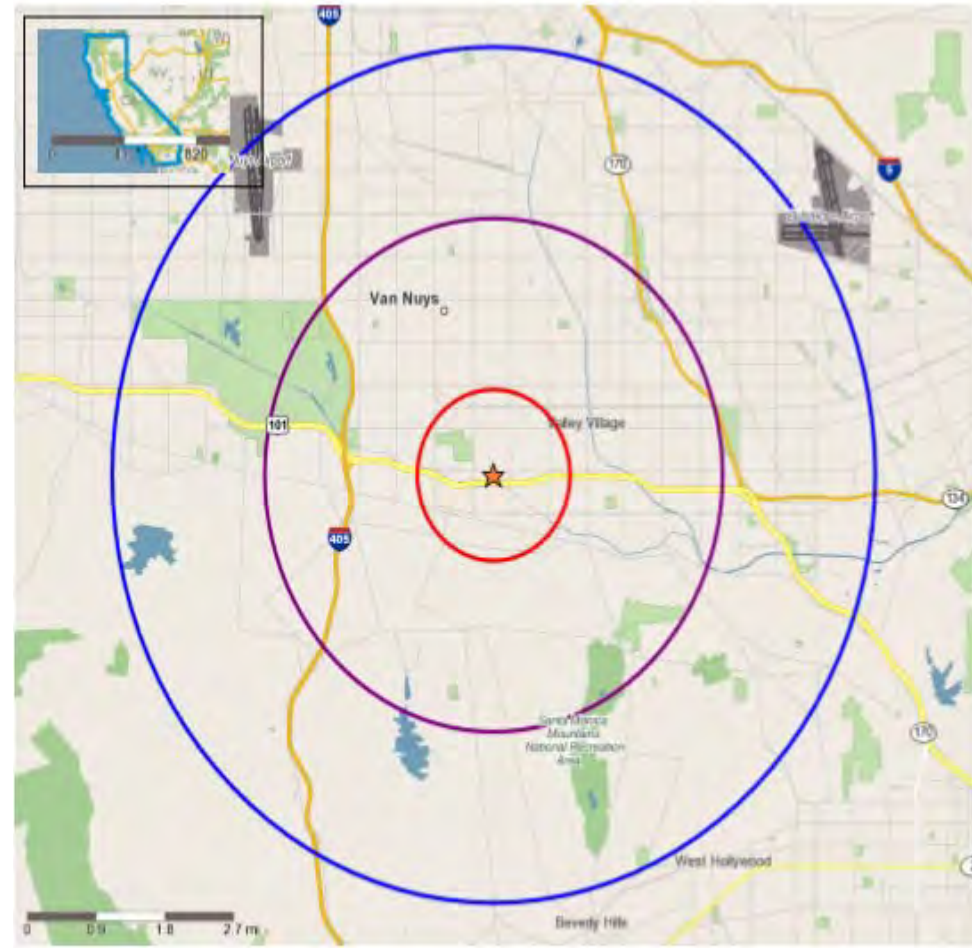

Copyright 2006-2014 TomTom. All rights reserved. This material is proprietary and the subject of copyright protection, database right protection and other intellectual property rights owned by TomTom or its suppliers. The use of this material is subject to the terms of a license agreement. Any unauthorized copying or disclosure of this material will lead to criminal and civil liabilities.

- Trade Areas (in miles) - 1
- Trade Areas (in miles) - 3
- Trade Areas (in miles) - 5